

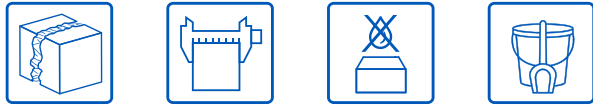

PRE-BLENDED WATERPROOF CONCRETE MIX

Pre-blended, waterproof, high strength professional grade structural concrete with special admixtures and fiber reinforcements.

Features & Benefits



- Waterproof, Professional Grade Fiber-reinforced Concrete
- Professional Grade: +4.500 PSI (31 MPa) Compressive Strength at 28 Days
- Fiber-reinforced for Strongest Anti-crack Performance
- Perfect Concrete Mix Design for DIY Applications

Application Areas

CONCREASY is a specially blended, professional grade structural concrete mixture for use in all types of concrete applications where high durability, effective shrinkage control, water impermeability and extended concrete service life are required. With its waterproof mix design, **CONCREASY** can be applied safely in all types of wet areas, while providing the perfect finish in all kinds of applications with its fiber reinforcements.

General application areas include:

- Residential and Commercial Concrete Applications: Architectural Structures, DIY Projects, Floor Slabs, Driveways, Sidewalks, Parking Areas, Patios, Pools, Platforms, Stairs, Basement Walls, Curbs, Walkways, Countertops, Concrete Furniture.
- Industrial Concrete Applications: Heavy-Duty Concretes, Precast, Concrete Roads, Marine Construction.
- Concrete Repair Applications.

Packaging and Coverage

CONCREASY comes in a 9.5 LBS (4.3 KG) bucket for the fastest, easiest, and most ergonomic use. 9.5 LBS (4.3 KG) **CONCREASY** covers approximately 2 Liters (0.07 ft³ / 0.002 m³)

Easy Coverage:

2 Liters of **CONCREASY**; ¾ inch (2 cm) covers (13x13 inch / 33x33 cm) area.



Technical and Physical Properties

Product Structure	Pre-blended concrete mix
Color	Gray
Compressive Strength	> 4.500 PSI (31 MPa) After 28 days of hardening
Slump Test Measurement	S4 Class, high workability, > 7" (180 mm)
Coverage	2 Liters (0.07 ft ³ / 0.002 m ³) per bucket.

Shelf Life and Storage Conditions

Recommended shelf life for unopened **CONCREASY** buckets is 1 year.

CONCREASY should be stored in a suitable warehouse with a relative humidity of 40% – 60% and an ambient temperature of around 68°F (20°C) in its original packaging in a closed and dry environment, protected from heat, water, moisture and direct sunlight.



PRE-BLENDED WATERPROOF CONCRETE MIX

Mixing Directions

You can get **CONCREASY** ready for application in just 3 steps

- **CONCREASY** only needs 400 ml (0.4 L) of water for mixing.
- Open the product bucket and take out the packaged special mixture.

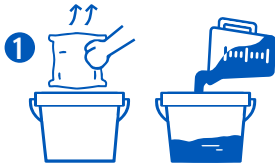

Half of the required water (200 ml / 0.2 L) is poured into the empty bucket.

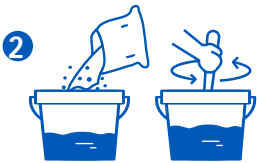

CONCREASY special mixture is poured into the bucket and premixing begins.



After a certain consistency is achieved, the remaining (200 ml / 0.2 L) water is poured into the bucket and mixed with a hand trowel for approximately 2-3 minutes.

Application Directions

- Extreme weather conditions should be avoided in outdoor applications.
- The optimum weather conditions for concrete application should be between 41°F (+5°C) to 86°F (+30°C).
- Application surface should be solid, impermeable, and free from dust, dirt, and particles.
- Necessary protection equipment should be available before the application. It is necessary to wear goggles to protect the eyes, a mask to prevent dust inhalation, protective clothing to protect the body, and gloves to protect the hands.

Application Directions

- A hand trowel of the appropriate size should be used for mixing **CONCREASY**.
- The substrate surface should be dampened with water before the application.
- After mixing **CONCREASY**, the high-performance concrete obtained should be poured into the form.
- After **CONCREASY** is completely filled to the mold level, the concrete surface should be leveled with a trowel.
- After the application is completed, the most important step is the curing of the concrete surfaces against early age shrinkage cracks. In general, the first 1-week period following the concrete casting is very critical. Curing should be done using water and it should be ensured that the concrete surface is always wet with water.
- The curing process should be done using a curing blanket and the concrete surface should constantly be saturated with water.
- After the application is completed, the surface can be opened to foot traffic in 24 hours and to vehicle traffic after 3 days.

Disclaimer

The directions section in this document related to the use of **CONCREASY** is only offered as a suggestion and may vary depending on the end user's intended use of the product. All risks and responsibilities arising from issues such as mixture, application, use of the product alone or in combination with additional products belong to the customer. We declare that any loss and/or cost arising from the use of the product in accordance with or not in accordance with the technical data sheet is not binding for the **CONCREASY** product, and all binding is on the customer's side.